

# 22 EARLSFORT COURT

*16 Hatch Street Lower, Dublin 2*

**FOR SALE**



BER D1



# 22 EARLSFORT COURT

An exceptional opportunity to rent a beautifully furnished two-bedroom second floor apartment situated in this highly desirable development in the heart of Georgian Dublin.

Earlsfort Court is situated on Hatch Steet in Dublin 2, a short walk from St. Stephens Green and Grafton Street. No 22 is a practically designed, beautifully presented, two-bedroom second floor apartment spanning approximately 73 sq.m/ 786 sq.ft. The apartment has been exceptionally well maintained and takes full advantage of its natural light throughout. Perfectly positioned in the heart of Dublin 2, this location offers unparalleled convenience. A wide range of amenities surrounds you and the area is also exceptionally well-connected, with the DART, LUAS, and Dublin Bus all within easy access.













## ACCOMMODATION

On entering the apartment, you are welcomed by a spacious entrance hallway with wooden flooring. The hallway includes hot press, offering additional convenient storage and intercom access. Leading off the hallway is a bright and spacious living/dining area featuring a black-wood surround fireplace and marble insert. This room is ideal for both relaxation and entertaining, with two good sized windows that flood the space with natural light. Adjacent to the living area is the open plan tiled kitchen, fitted with contemporary white high gloss units, ample storage space, and integrated appliances to include fridge/freezer, dishwasher, oven with four ring hob and extractor fan.

The property comprises two double bedrooms, both with fitted wardrobes, the main bedroom is well proportioned and benefits from en-suite shower room. A stylish main bathroom with full sized bath completes the accommodation.





## LOCATION • FEATURES

Tucked away just off Hatch Street in the heart of Dublin 2, 22 Earlsfort Court offers a rare opportunity to enjoy city living at its most convenient. This prime location places you just moments from St Stephen's Green, the Iveagh Gardens, and Grafton Street, with its vast array of shops, cafés, and restaurants.

Set within a well-maintained development, the property enjoys a peaceful setting while still being at the centre of it all. Whether you're commuting or exploring the city, excellent transport links are right on your doorstep, including the

LUAS at Harcourt Street, the DART at Pearse Station, and numerous Dublin Bus routes.

The area is also home to some of Dublin's most iconic cultural and business landmarks, including the National Concert Hall, Iveagh House, and many leading law firms and tech companies. For those who value both lifestyle and location, 22 Earlsfort Court delivers the perfect balance of comfort, convenience, and city charm.

### VIDEO

Click link below to view the virtual tour

 [22 Earlsfort Court Video](#)

### LOCATION MAP

Click below to view the location map for 7 Kilmore.

 [D02 FH93](#)



### SIZE

73 sq. m / 786 sq. ft. Approx.

### BER

BER: D1

BER No: 104955828

Energy Performance Indicator: 243.08 kWh/m<sup>2</sup>/yr

### FEATURES

- Spacious accomodation
- Lift access
- Intercom
- Electric Central Heating
- Furnished
- Double glazed windows throughout
- Prime Dublin 2 location

## VIEWING

By appointment with Knight Frank.

## CONTACT



**Tara Jerman**

Senior Sales Negotiator  
Assoc SCSi

E: [tara.jerman@ie.knightfrank.com](mailto:tara.jerman@ie.knightfrank.com)



**Guy Craigie**

Director of Residential  
ASCSI / ARICS

E: [guy.craigie@ie.knightfrank.com](mailto:guy.craigie@ie.knightfrank.com)

## THINKING OF SELLING?

If you are considering a sale and would like a free residential valuation to find out how much your home could be worth, please [click here](#) to get in touch with our team of experts.

**KnightFrank.ie**

T: +353 1 634 2466

E: [residential@ie.knightfrank.com](mailto:residential@ie.knightfrank.com)

# FLOOR PLANS

## Floor Plan

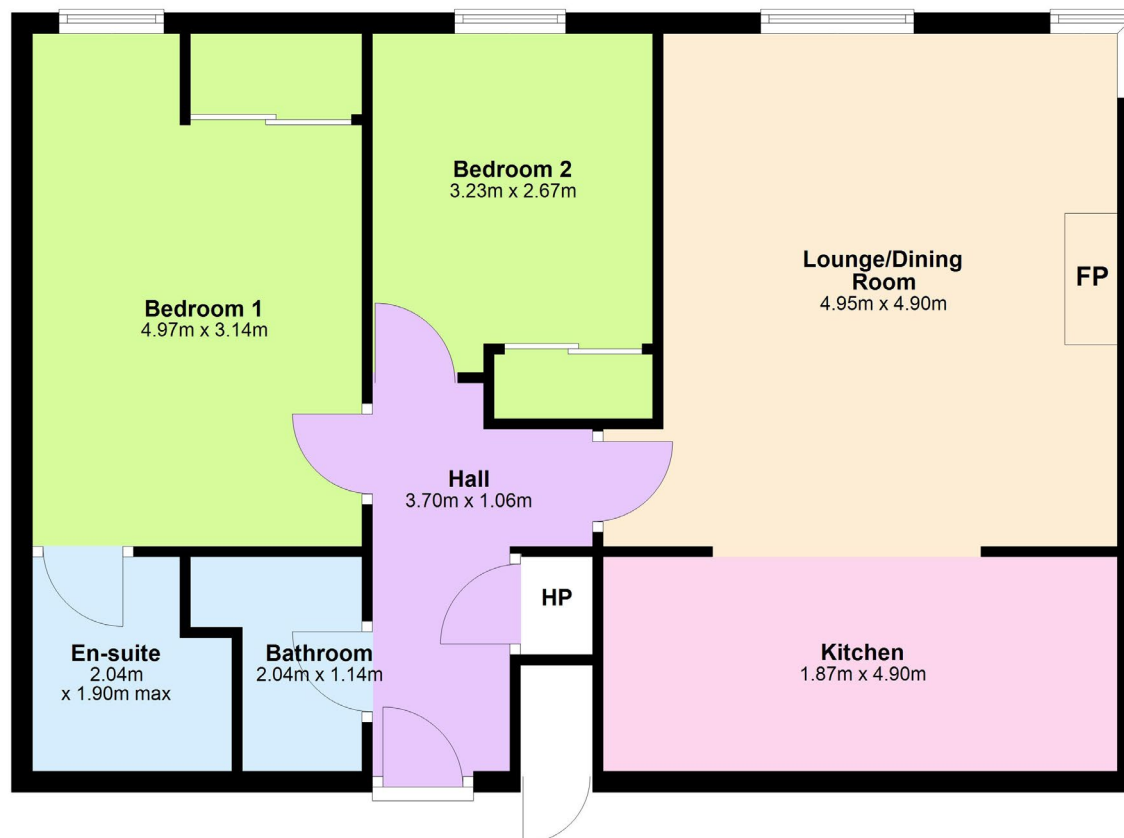

Not to scale, floorplans are for identification purposes only and measurements are approximate.



20-21 Upper Pembroke Street,  
Dublin 2

Tel: +353 1 634 2466

**KnightFrank.ie**

Follow us on:



## CONDITIONS TO BE NOTED

These particulars are issued by HT Meagher O'Reilly New Homes Limited trading as Knight Frank on the understanding that all the negotiations are conducted through them. These particulars do not constitute, nor constitute any part of an offer or contract. All statements, descriptions, dimensions, references to condition, permissions or licenses of use or occupation, access and other details are for guidance only and are made without responsibility on the part of HT Meagher O'Reilly New Homes Limited trading as Knight Frank or the vendor/landlord. None of the statements contained in these particulars, as to the property are to be relied upon as statements or representations of fact and any intending purchaser/tenant should satisfy themselves (at their own expense) as to the correctness of the information given. Prices are quoted exclusive of VAT (unless otherwise stated) and all negotiations are conducted on the basis that the purchaser/tenant shall be liable for any VAT arising on the transaction. The vendor/landlord do not make or give, and neither HT Meagher O'Reilly New Homes Limited trading as Knight Frank or any of their employees has any authority to make or give any representation or warranty whatsoever in respect of this property. Knight Frank is a registered business name of HT Meagher O'Reilly New Homes Limited. Company Reg. No. 428289. PSR Reg. No. 001880.